



SUBARU

Name : AERO SPLASH GUARD/FRONT SET

Part No. : J1010FJ901##

IMPREZA

Installation manual

Component parts

No.	Part name	Quantity
①	Aero Splash Guard F-RH	1
②	Aero Splash Guard F-LH	1
③	J-Nut	2
④	Bolt	2
⑤	Washer	2
⑥	Push Rivet (φ10)	2
⑦	Push Rivet (φ16)	2
⑧	Installation Instruction	1

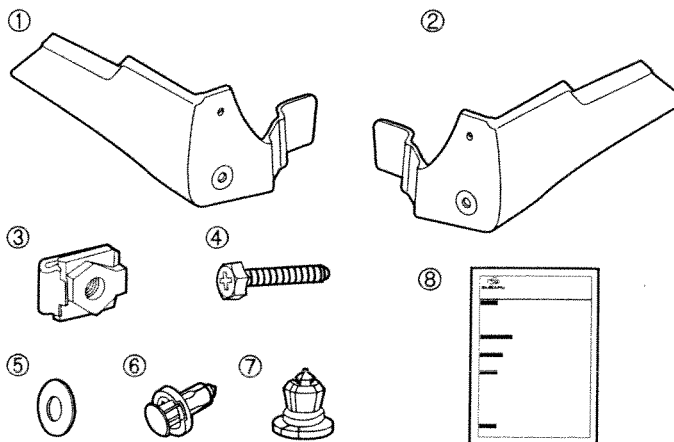

Tools

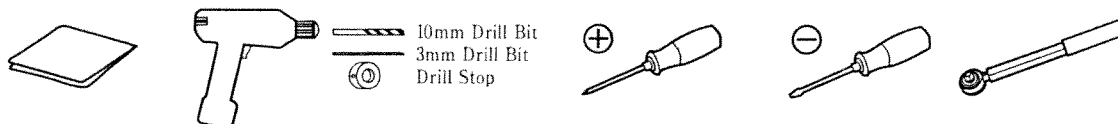

Important notes

Be careful when driving after installing this product as ground clearance at the wheel arch decreased by approximately 0.5 cm (0.2 inches).

Fahren Sie nach der Installation dieses Produkts vorsichtig, da die Bewegungsfreiheit 0.5 cm (0.2 Zoll) reduziert ist.

Tenga cuidado cuando conduzca después de instalar este producto, debido a que la distancia al suelo en el arco disminuye aproximadamente 0.5 cm (0.2 pulgadas), respectivamente.

Faites attention lors de la conduite du véhicule après la pose de ce produit, au niveau du passage de étant réduite d' environ 0.5cm (0.2 pouces) respectivement.

Prestare attenzione durante la guida dopo l'installazione di questo prodotto stata ridotta distanza da terra sul circa 0.5 cm (0.2 pollici).

If the surface temperature is below 60°F(15°C) heat the double sided tape and side under spoiler surface to a temperature of 77°F - 104°F(25°C - 40°C).

Liegt die Klebstoffoberflächentemperatur unter 60°F(15°C), doppelseitiges Klebeband und seite unter spoiler auf eine Temperatur von 25°C - 40°C(77°F - 104°F) erwärmen.

Si la temperatura de la superficie es inferior a 60°F(15°C), caliente la cinta de doble cara y la superficie del lado bajo spoiler hasta una temperatura de 77°F - 104°F(25°C - 40°C).

Si la température de surface adhésive recommandée est inférieure à 60°F(15°C), chauffez le ruban adhésif double-face et la surface du côté sous becquet à une température de 77°F - 104°F(25°C - 40°C).

Se la temperatura della superficie è inferiore a 60°F(15°C), riscaldare il nastro biadesivo e la superficie del lato sotto spoiler ad una temperatura di 77°F - 104°F(25°C - 40°C).

Meaning of Characters



Remove



Install

T

Tightening Torque



Discard



Re-use

Hardware Set : J1010FJ907

Work outline

1

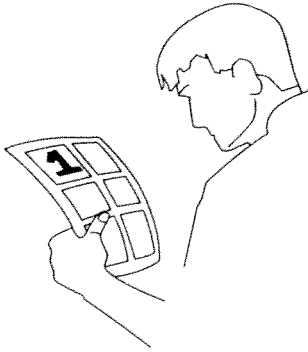

2

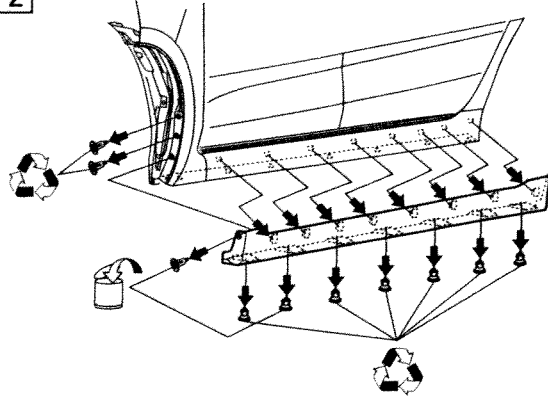

3

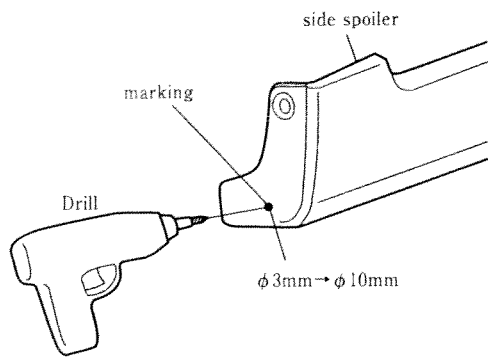

4

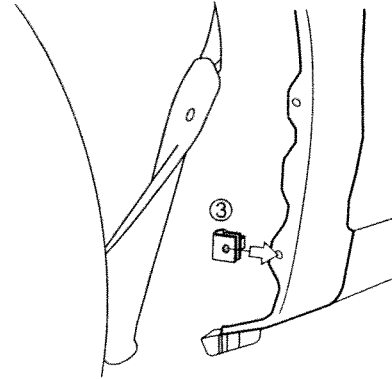

5

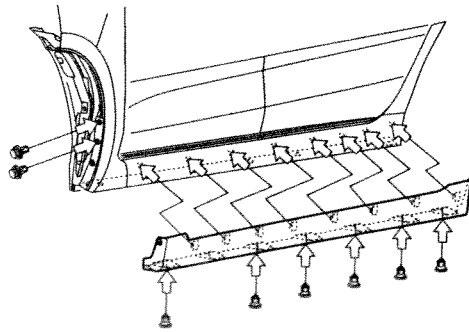

6

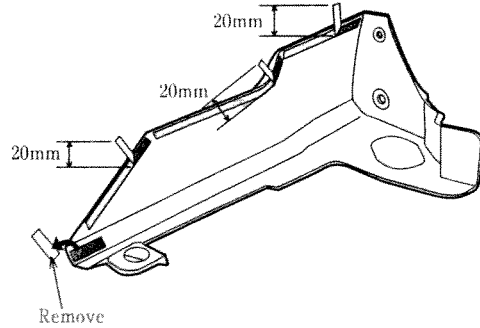

Peel off small sections of liner so they can be removed once the part is in position on the vehicle.

7

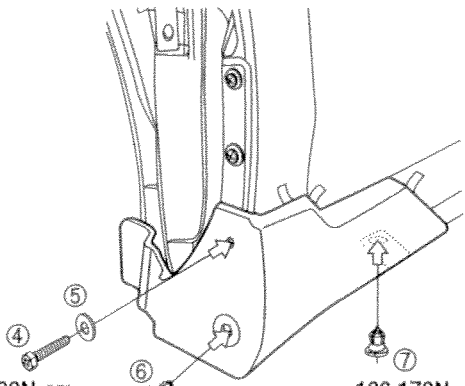

T:180-220N-cm
(16-19.5 N-lbs)

130-170N
(29.3-38.2 lbf)

8

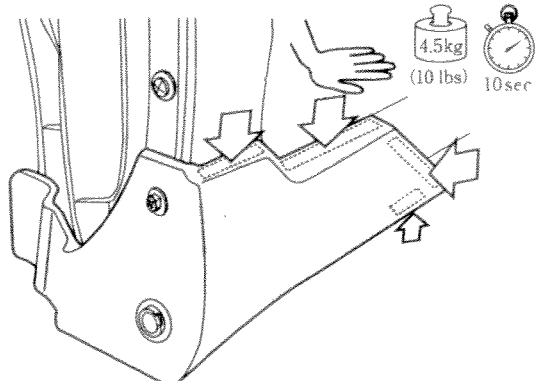

Completely remove tape liner and press firmly in the direction shown.



SUBARU

Name : AERO SPLASH GUARD/REAR SET
Part No. : J1010FJ954##

IMPREZA

Installation manual

Component parts

No.	Part name	Quantity
①	Aero Splash Guard R-RH	1
②	Panel R-RH	1
③	Aero Splash Guard R-LH	1
④	Panel R-LH	1
⑤	J-Nut	6
⑥	Bolt	6
⑦	Washer	6
⑧	Push Rivet (φ8)	2
⑨	Push Rivet (φ10)	4
⑩	Push Rivet (φ10)	2
⑪	Installation Instruction	1

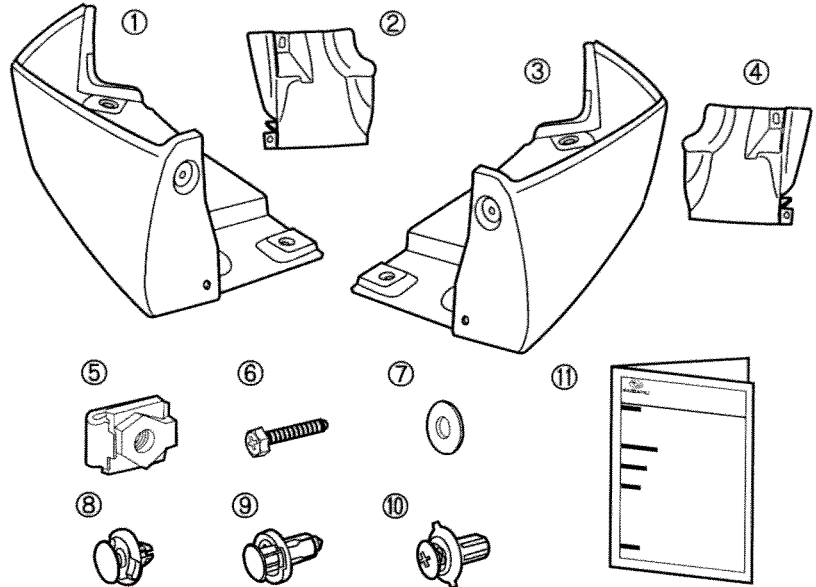

Tools



Important notes

Be careful when driving after installing this product as ground clearance at the wheel arch decreased by approximately 3.7 cm (1.5 inches).

Fahren Sie nach der Installation dieses Produkts vorsichtig, da die Bewegungsfreiheit 3.7 cm (1.5 Zoll) reduziert ist.

Tenga cuidado cuando conduzca después de instalar este producto, debido a que la distancia al suelo en el arco disminuye aproximadamente 3.7 cm (1.5 pulgadas), respectivamente.

Faites attention lors de la conduite du véhicule après la repose de ce produit, au niveau du passage de étant réduite d' environ 3.7cm (1.5 pouces) respectivement.

Prestare attenzione durante la guida dopo l'installazione di questo prodotto stata ridotta distanza da terra sul circa 3.7 cm (1.5 pollici).

If the surface temperature is below 60°F (15°C) heat the double sided tape and bumper surface to a temperature of 77°F - 104°F (25°C - 40°C).

Liegt die Klebstoffoberflächentemperatur unter 60°F (15°C), doppelseitiges Klebeband und Stoßstangenoberfläche auf eine Temperatur von 25°C - 40°C (77°F - 104°F) erwärmen.

Si la temperatura de la superficie es inferior a 60°F (15°C), caliente la cinta de doble cara y la superficie del parachoques hasta una temperatura de 77°F - 104°F (25°C - 40°C).

Si la température de surface adhésive recommandée est inférieure à 60°F (15°C), chauffez le ruban adhésif double-face et la surface du pare-chocs à une température de 77°F - 104°F (25°C - 40°C).

Se la temperatura della superficie è inferiore a 60°F (15°C), riscaldare il nastro biadesivo e la superficie del paraurti ad una temperatura di 77°F - 104°F (25°C - 40°C).

Meaning of Characters

 Remove

 Install

 Tightening Torque

 Discard

Work outline

1

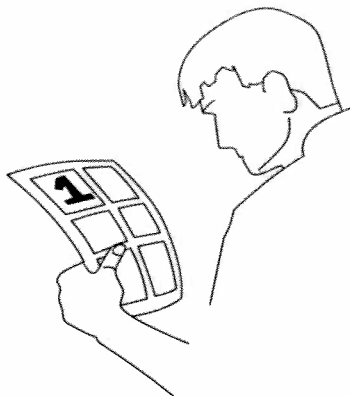

2

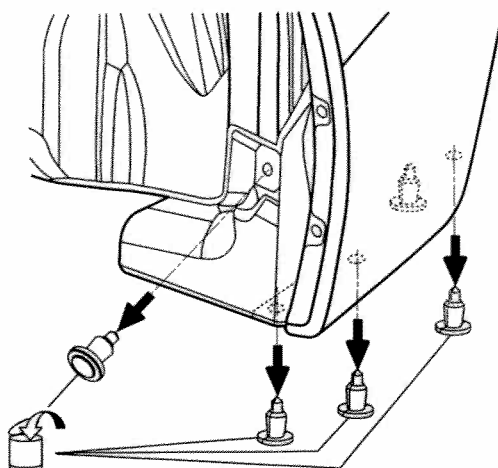

3

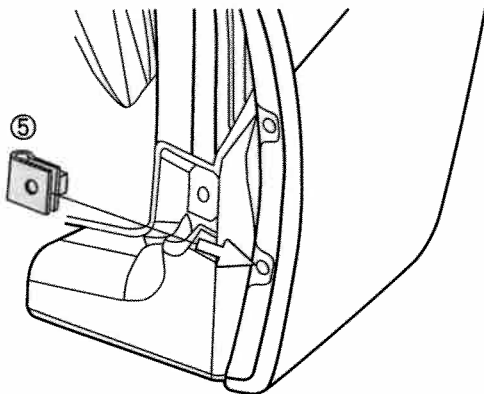

4

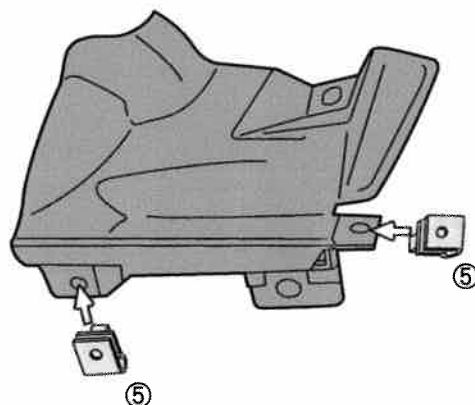

5

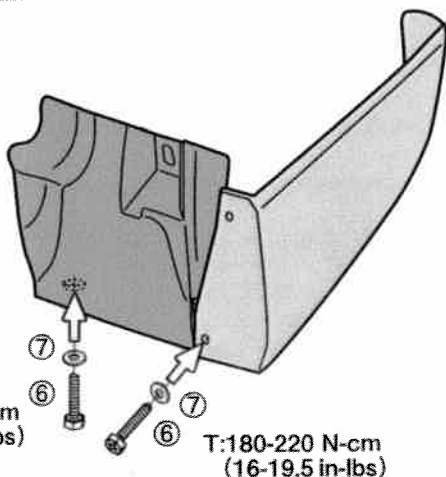

T:180-220 N-cm
(16-19.5 in-lbs)

T:180-220 N-cm
(16-19.5 in-lbs)

6

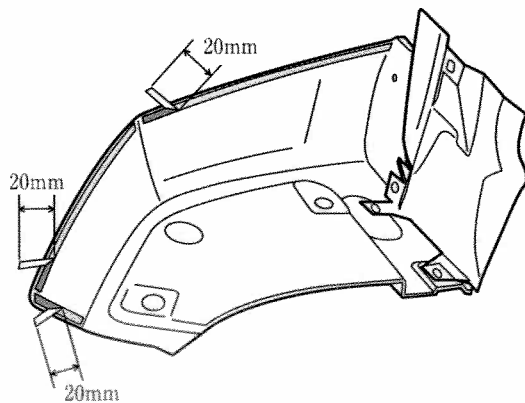

Peel off small sections of liner so they can be removed once the part is in position on the vehicle.

7

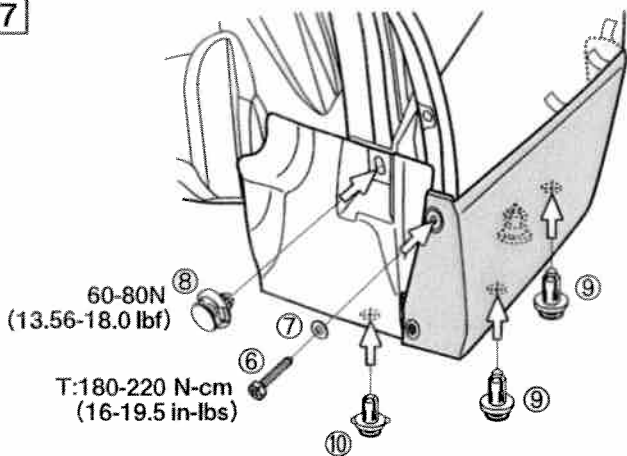

60-80N
(13.56-18.0 lbf)

T:180-220 N-cm
(16-19.5 in-lbs)

8

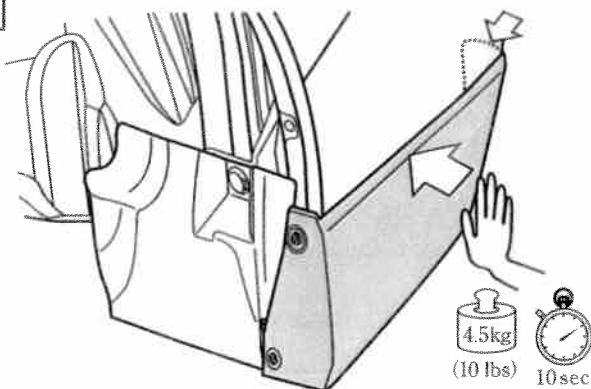

Completely remove tape liner and press firmly in the direction shown.